

8100-MO (5 PLY)

PARTICLE CORE FOR MODERATE USE

- ❶ **STILES:** 1 3/16" (30 mm) clear, finger-jointed, low-density wood
- ❷ **TOP AND BOTTOM RAILS:** 1 3/16" (30 mm) low-density wood or SCL, (LVL FSC) or laminated strand lumber (LSL), manufacturer's choice
- ❸ **CORE:** Solid particleboard. Available UFF/FSC (LD-2)
- ❹ **FACES:** Wood veneer (choice of face veneers: 2 ply plywood), hardboard panel or plastic laminate glued to composite crossband. Available UFF/FSC

LOCK BLOCK: Integrated

GLUE: Type 1 PVA Cross-link (UFF)

INTERIOR USE

WARRANTY: 3 years

OPTIONS

| 20 minute fire rating, specify 8120-MO

| Wood veneer glued to veneer plywood (3 ply plywood) (7 ply door)

| * To get M.R. 7.0: **Option 1:** specify particleboard core UFF/FSC 8100-MO UFF/FSC) and FSC faces to optimize. **Option 2:** specify agrifibre core (8100-MO-AF) and FSC wood veneer faces, only when M.R. 6.0 is also required

| ** To get I.E.Q. 4.4, specify particleboard core UFF/FSC (8100-MO UFF/FSC) or agrifibre core (8100-MO-AF) and UFF or UFF/FSC wood veneer faces

NOTE

| Dimensions are nominal before trimming

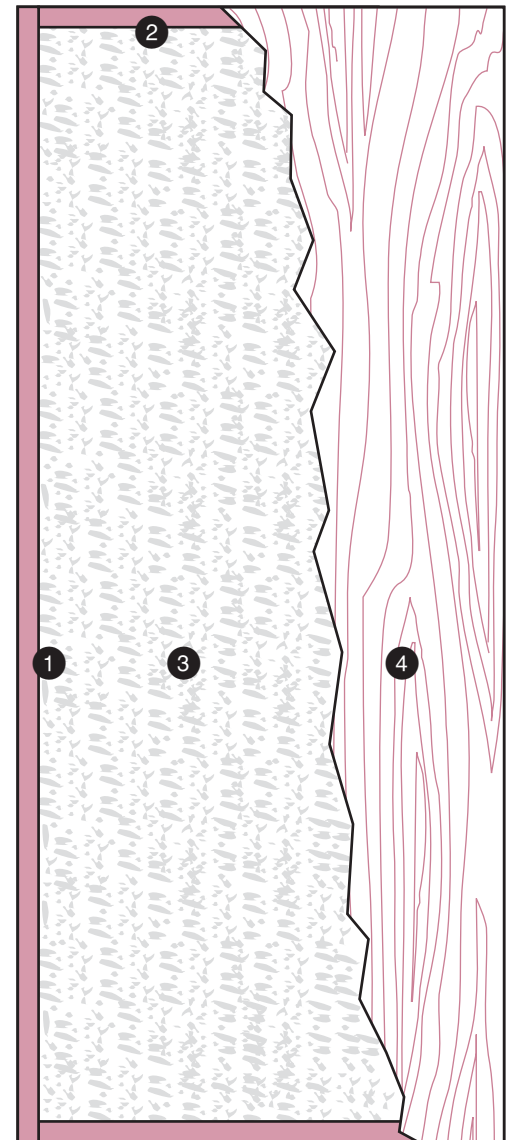

LEED ELIGIBLE CREDITS	M.R.		I.E.Q.				
	4.1	4.2	5.1	5.2	6.0	7.0	4.4 (UFF)
	✓	✓	✓	✓		*	**

❶ STILES MO

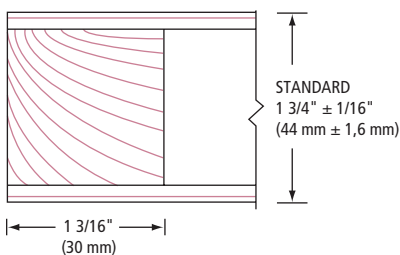

❷ RAILS

