

**SOUND RATED**  
(Heavy Duty)

**SR39-ME / SR3920-ME**

**SOUND RETARDANT DOORS 39 dB,  
SINGLE OR PAIRED, FOR INTENSIVE USE**

Our doors are certified and tested by Architectural Testing up to 4'X8' single and 6'X7' paired. Oversize constructions available without STC or fire label.

- 1 STILES:** 1 3/16" (30 mm) structural composite lumber with 7/8" (22 mm) hardwood matched with faces.
- 2 RAILS:** 3 5/16" (84 mm) at top and bottom.
- 3 CORE:** Sound dampening core
- 4 FACES:** Wood veneer (choice of face veneers; 2 ply plywood), hardboard panel or plastic laminate glued to composite crossband.

**GLUE:** Type 1 PVA Cross-link.

**INTERIOR** use

**SEAL COMPONENT KIT** no. 10

**SEAL COMPONENT KIT** no. 13

(Pair of doors)

**WARRANTY:** 3 years.

**NOTE**

| Dimensions are nominal before trimming.

**OPTIONS**

- | 20 min fire rating: specify SR3920.
- | Wood veneer glued to plywood veneer (3 ply plywood).

**WARNING**

- | Use of gaskets other than those tested may affect STC rating. Walls components, frame installation and joints can also impact STC ratings.

**IMPORTANT**

- | Gaskets and threshold included.
- | Limited dimensions.

**LEED CONTRIBUTION OPTIONS**

- | EPD
- | Recycled content
- | FSC
- | NAUF or ULEF (on request)

**PERFORMANCE MEASUREMENT**

- | ANSI/WDMA 1.S.1A
- | ASTM E 90-02, 413-87, E 1332-90, E 2235-03
- | AWS
- | Intertek WH-ETL
- | NFPA 80

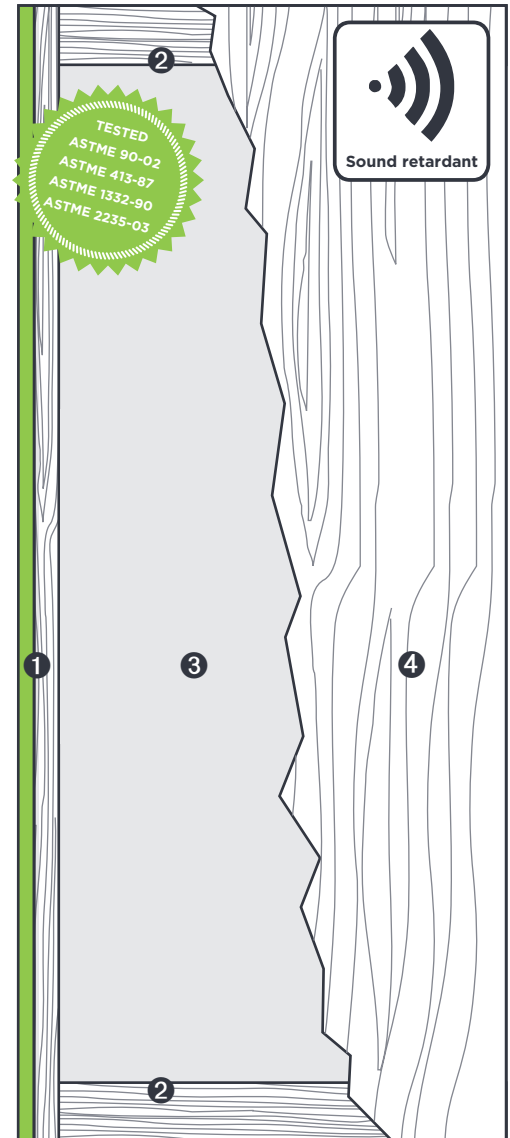

**1 STILES ME**

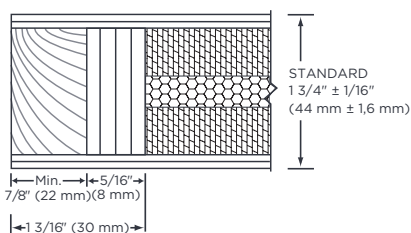

**2 RAILS**

