

SR4545-ME

SOUND RETARDANT DOORS

Our doors are certified and tested by Architectural Testing in accordance with ASTM E 90-02, ASTM E 413-87, ASTM E 1332-90 and ASTM E 2235-03 up to 36" X 84" for SR4545. Oversize constructions available without STC label and/or fire label.

- ❶ **STILES:** non combustible material with **1/16" (1.6 mm)** intumescent and **7/8" (22 mm)** hardwood matched with faces, for a total width of **1 1/2" (38 mm)**.
- ❷ **TOP RAIL:** non combustible material with **1/16" (1.6 mm)** intumescent and **7/16" (11 mm)** hardwood at top and bottom, for a total width of **3 1/2" (89 mm)**.
- ❸ **BOTTOM RAIL:** **4" (102 mm)** non combustible material.
- ❹ **CORE:** Sound dampening core
- ❺ **FACES:** Wood veneer (choice of face veneers; 2 ply plywood), hardboard panel or plastic laminate glued to composite crossband. Available NAUF/FSC.

LOCK BLOCK (1): Blocking required, non-combustible material at manufacturer's choice.

GLUE: Type 1 PVA Cross-link (NAUF).

INTERIOR use

SR45: SEAL COMPONENT KIT no. 10

WARRANTY: 3 years.

OPTIONS

- | 45 min fire rating: specify SR4545.
- | Sound retardant 45STC, specify SR45.
- | Light opening up to 216 sq. inches (vision).
- | Wood veneer glued to plywood veneer (3 ply plywood).

WARNING

- | Use of gaskets other than those tested may affect STC rating. Walls components, frame installation and joints can also impact STC ratings.

IMPORTANT

- | Gaskets system included with STC door configuration.
- | Limited dimensions.
- | For LEED credits, contact us.

NOTE

- | Dimensions are nominal before trimming.

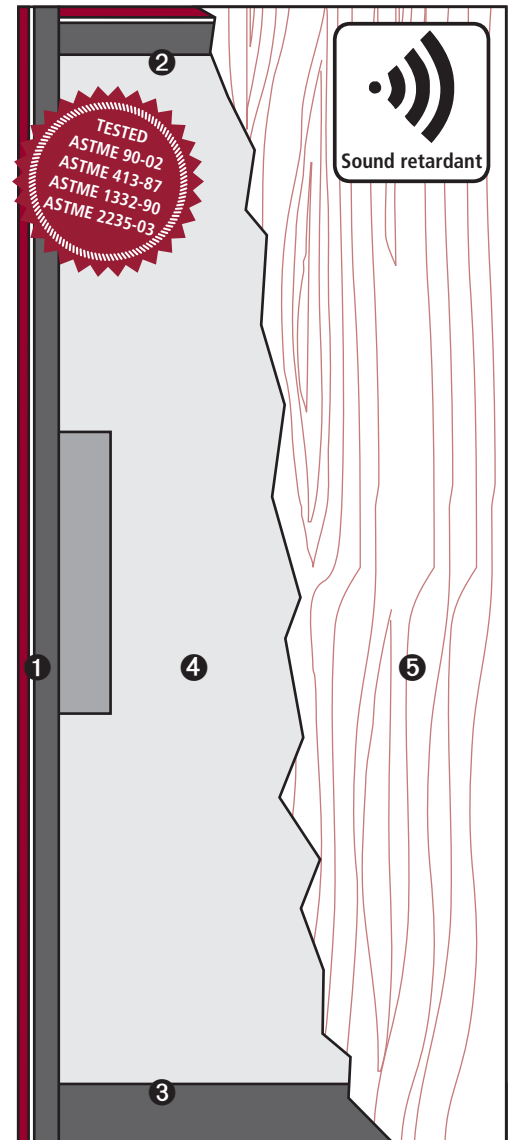

❶ STILES ME

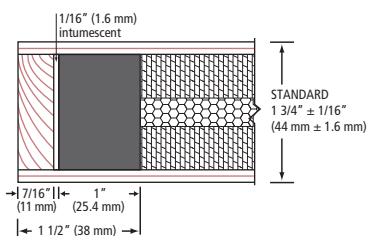

❷ TOP RAIL

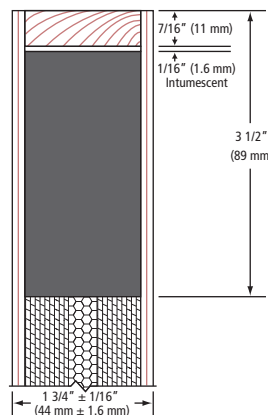

❸ BOTTOM RAIL

