

PARTICLE CORE (Standard Duty)

8100-MO / 8120-MO (5 ply)

FOR MODERATE USE

- 1 STILES:** 1 3/16" (30 mm) clear, finger-jointed, low-density wood.
- 2 TOP AND BOTTOM RAILS:** 1 3/16" (30 mm) low-density wood or SCL, (LVL) or laminated strand lumber (LSL), manufacturer's choice.
- 3 CORE:** Solid particleboard. Density of 28-32 lbs per cubic foot.
- 4 FACES:** Wood veneer (choice of face veneers; 2 ply plywood), hardboard panel or plastic laminate glued to composite crossband.

LOCK BLOCK: Integrated.

GLUE: Type 1 PVA Cross-link.

INTERIOR use

WARRANTY: 3 years.

NOTE

Dimensions are nominal before trimming.

OPTIONS

- 20 min fire rating, specify 8120-MO.
- STC sound rating not available.

LEED CONTRIBUTION OPTIONS

- EPD
- Recycled content
- FSC
- NAUF or ULEF (on request)

PERFORMANCE MEASUREMENT

- ANSI/WDMA 1.S.1A
- ANSI A208-1 (particle board LD-1/LD2)
- ASTM-D1037 and D198-98 (LSL)
- ASTM-D5456-93 (LVL)
- AWS
- Intertek WH-ETL
- NFPA 80

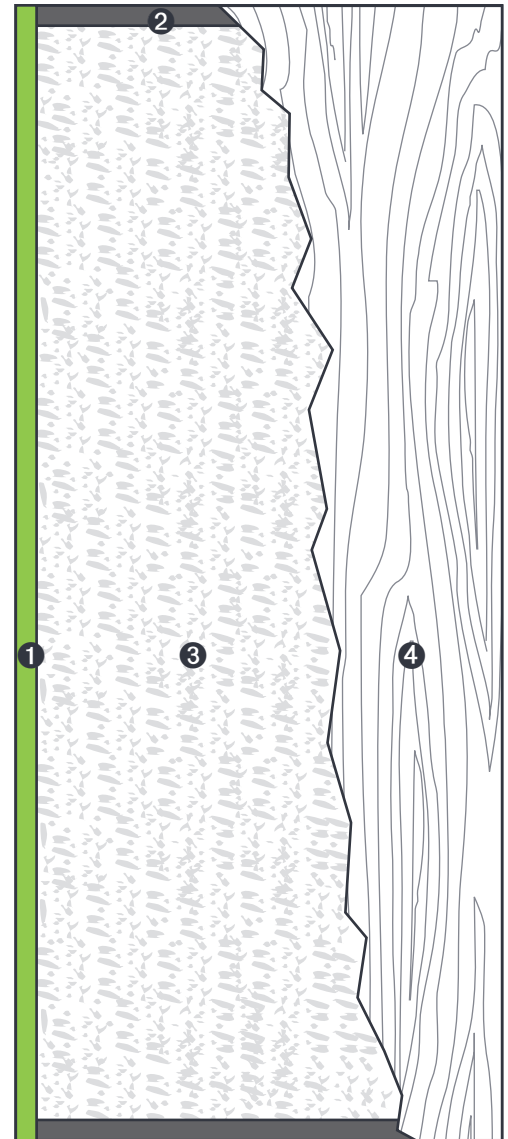

1 STILES MO

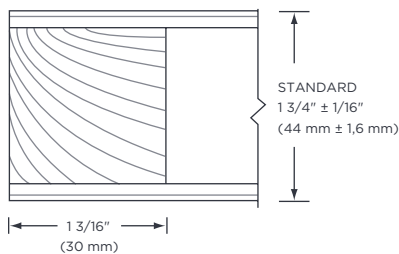

2 RAILS

