

MINERAL
(Heavy Duty)

RMC45/RMC60
RMC90-MO/VE (5 ply)

45-60-90 MIN FIRE-RESISTANT DOOR, NEUTRAL PRESSURE, FOR INTENSIVE USE

- 1 STILES:** Special construction compliant with W/H label requirements. High-density mineral and/or untreated hardwood (minimum of **3/4" (19 mm)**):
MO: Manufacturer's choice.
VE: Covered with 1/32" (0.7938 mm) of wood veneer, matched with faces.
Bonded to core.

- 2 TOP AND BOTTOM RAILS:** Special construction compliant with W/H label requirements. Mineral and/or untreated hardwood, manufacturer's choice (minimum of **1 3/8" (3 mm)**). **Bonded to core.**

- 3 CORE:** Non-combustible mineral.

- 4 FACES:** Wood veneer (choice of face veneers; 2 ply plywood), hardboard panel or plastic laminate glued to composite crossband.

GLUE: Type 1 PVA Cross-link.

MAXIMUM DIMENSIONS: single - 4' x 1 0'; double - 8' x 9'.

WARNING

Pre-machining must be done in factory or by an authorized distributor in order to maintain our warranty and comply with W/H requirements (see NFPA 80).

Certain applications may require reinforcement. Pilot holes required.

NOTE: Max. 1/2" (13 mm) cut allowed at bottom of door upon installation (see NFPA 80).

INTERIOR use

WARRANTY: Lifetime

For technical information, please consult our "RCM45/60/90 Technical Specification" sheet.

NOTE

Dimensions are nominal before trimming.

OPTIONS

Positive pressure available (PP) or RCM45/60/90-MO/VE (PP).

Hardware reinforcements.

SOUND RATED OPTION

Available 32dB depending on configuration of soundproofing hardware.

For optimization, see our soundproof construction.

LEED CONTRIBUTION OPTIONS

EPD

Recycled content

NAUF or ULEF (on request)

PERFORMANCE MEASUREMENT

ANSI/WDMA 1.S.1A

AWS

Intertek WH-ETL

NFPA 80

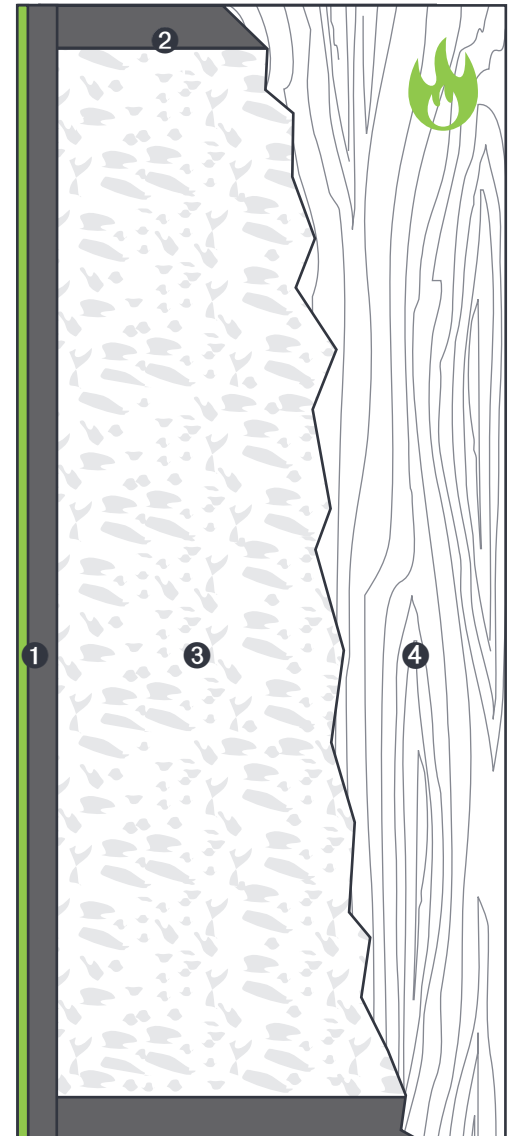

1 STILES MO

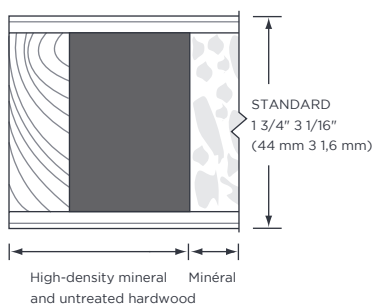

1 STILES VE

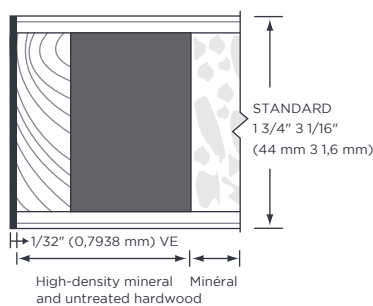

2 RAILS

