

SOUND RATED
(Heavy Duty)

SR40-ME / SR4020-ME

SOUND RETARDANT DOORS 40 dB FOR INTENSIVE USE

Our doors are certified and tested by Architectural Testing up to 48" X 96". Oversize constructions available without STC or fire label.

- 1 STILES:** 1 3/16" (30 mm) structural composite lumber with 7/8" (22 mm) hardwood matched with faces.
- 2 RAILS:** 3 5/16" (84 mm) at top and bottom.
- 3 CORE:** Sound dampening core
- 4 FACES:** Wood veneer (choice of face veneers; 2 ply plywood), hardboard panel or plastic laminate glued to composite crossband.

GLUE: Type 1 PVA Cross-link.

INTERIOR use

SR40: SEAL COMPONENT KIT no. 10

WARRANTY: 3 years

NOTE

Dimensions are nominal before trimming.

OPTIONS

20 min fire rating: specify SR4020

Wood veneer glued to plywood veneer (3 ply plywood).

WARNING

Use of gaskets other than those tested may affect STC rating. Walls components, frame installation and joints can also impact STC ratings.

IMPORTANT

- Gaskets and threshold included.
- Limited dimensions.

LEED CONTRIBUTION OPTIONS

- EPD
- Recycled content
- FSC (on request)
- NAUF or ULEF (on request)

PERFORMANCE MEASUREMENT

- ANSI/WDMA 1.S.1A
- ASTM E 90-02, 413-87, E 1332-90, E 2235-03
- AWS
- Intertek WH-ETL
- NFPA 80

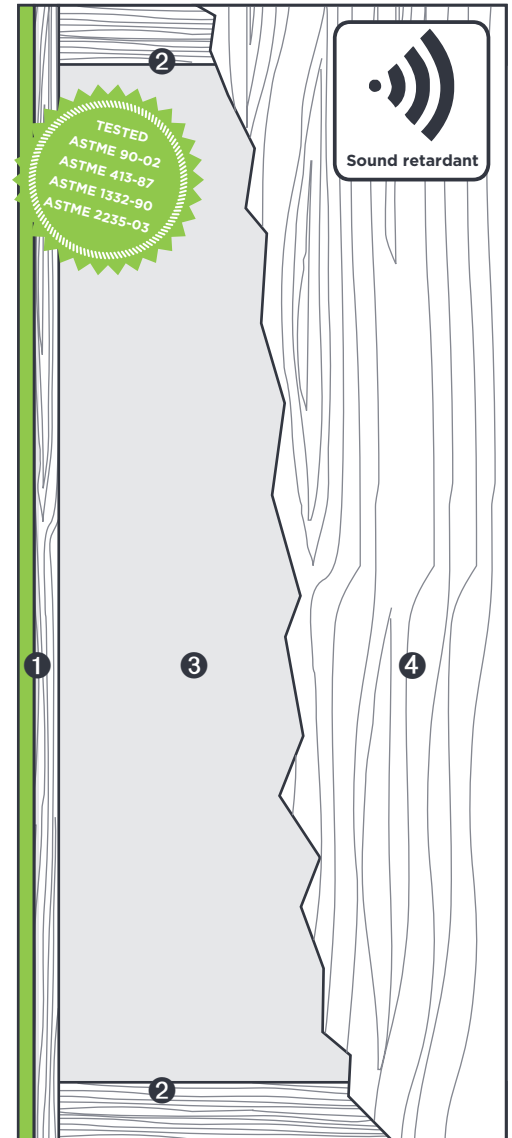

1 STILES ME

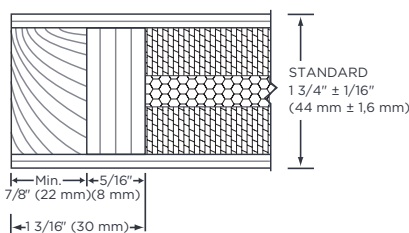

2 RAILS

