

SOUND RATED (Heavy Duty)

SR43-ME / SR4320-ME

SOUND RETARDANT DOORS 43 dB, SINGLE OR PAIRED, FOR INTENSIVE USE

Our doors are certified and tested by Architectural Testing up to 4'X8' single and 6'X7' paired. Oversize constructions available without STC or fire label.

- 1 **STILES:** 1 3/16" (30 mm) structural composite lumber with 7/8" (22 mm) hardwood matched with faces.
- 2 **RAILS:** 3 5/16" (84 mm) at top and bottom.
- 3 **CORE:** Sound dampening core
- 4 **FACES:** Wood veneer (choice of face veneers; 2 ply plywood), hardboard panel or plastic laminate glued to composite crossband.

GLUE: Type 1 PVA Cross-link.

INTERIOR use

SEAL COMPONENT KIT no. 10

SEAL COMPONENT KIT no. 13

(Paire of doors)

WARRANTY: 3 years.

NOTE

Dimensions are nominal before trimming.

OPTIONS

20 min fire rating: specify SR4320

45 min fire rating: specify SR4345

Wood veneer glued to plywood veneer (3 ply plywood).

WARNING

Use of gaskets other than those tested may affect STC rating. Walls components, frame installation and joints can also impact STC ratings.

IMPORTANT

Gaskets and threshold included.

Limited dimensions.

LEED CONTRIBUTION OPTIONS

EPD

Recycled content

FSC (on request)

NAUF or ULEF (on request)

PERFORMANCE MEASUREMENT

ANSI/WDMA 1.S.1A

ASTM E 90-02, 413-87, E 1332-90, E 2235-03

AWS

Intertek WH-ETL

NFPA 80

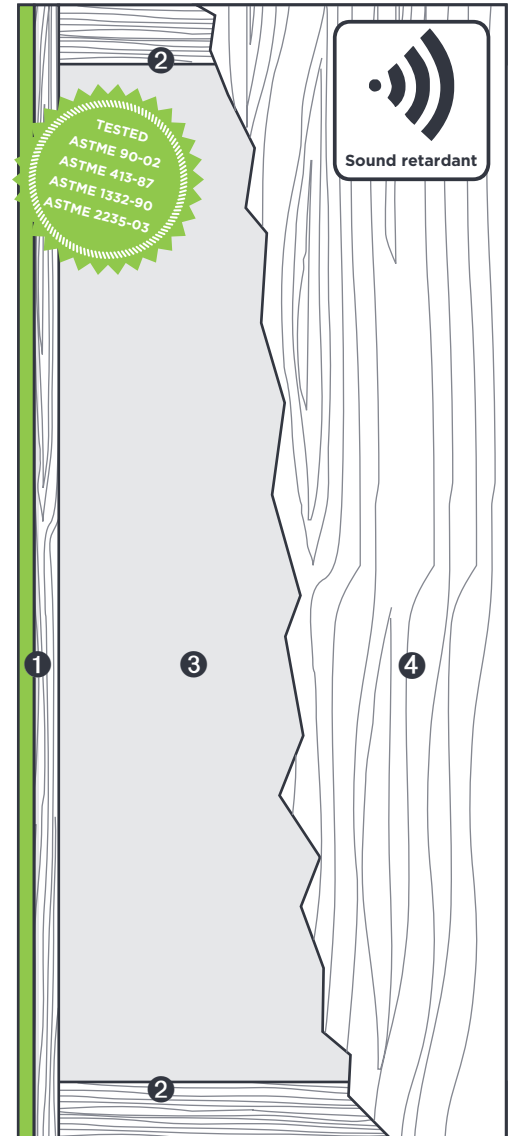

1 STILES ME

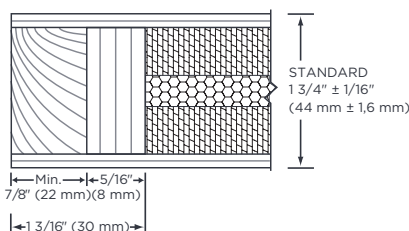

2 RAILS

